

DEPARTMENT OF THE ARMY TECHNICAL MANUAL

---

DIRECT SUPPORT, GENERAL SUPPORT,  
AND DEPOT MAINTENANCE MANUAL  
INCLUDING REPAIR PARTS AND  
SPECIAL TOOL LISTS

PISTOL, CALIBER .45, AUTOMATIC: M1911A1,  
WITH HOLSTER, W/E  
(1005-673-7965)

PISTOL, CALIBER .45, AUTOMATIC: M1911A1,  
WITH HOLSTER, SHOULDER, W/E  
(1005-561-2003)

This copy is a reprint which includes current pages from Changes 1 through 4.

---

HEADQUARTERS, DEPARTMENT OF THE ARMY

APRIL 1968

**SAFETY PRECAUTIONS**

<b>WARNING,</b>	<b>REFERENCE</b>
Before starting an inspection, be sure to clear the weapon. DO NOT actuate the trigger until the weapon has been cleared. Inspect the chamber, to insure that it is empty, and check to see that no ammunition is in position to be introduced (magazine). Avoid having live ammunition in the vicinity of work area.	Par 2-6

**CHANGE )  
)  
No. 4)**

**HEADQUARTERS  
DEPARTMENT OF THE ARMY  
WASHINGTON, DC, 25 February 1976**

Direct Support, General Support and Depot Maintenance Manual  
Including Repair Parts and Special  
Tool Lists:

**PISTOL, CAL .45, AUTOMATIC: M1911A1, WITH HOLSTER; W/E  
(1005-00-673-7965)**

**PISTOL, CAL .45, AUTOMATIC: M1911A1, WITH HOLSTER,  
SHOULDER, W/E (1005-00-561-2003)**

---

**Current as of 28 November 1975.**

TM 9-1005-211-35, 4 April 1968, is Changed as follows:

Title is changed as shown above.

Appendix B is superseded as follows:

## APPENDIX B

### DIRECT SUPPORT AND GENERAL SUPPORT MAINTENANCE REPAIR PARTS AND SPECIAL TOOLS LIST (INCLUDING DEPOT MAINTENANCE REPAIR PARTS AND SPECIAL TOOLS)

---

#### SECTION I. INTRODUCTION

##### B-1. Scope

This appendix lists repair parts; special tools; test, measurement, and diagnostic equipment (TMDE); and other support equipment required for the performance of direct support and general support maintenance of the .45 cal automatic pistol.

##### B-2. General

This repair parts and special tools list is divided into the following sections:

*a. Section II. Repair Parts List.* A list of repair parts authorized for use in the performance of maintenance. The list also includes parts which must be removed for replacement of the authorized parts. Parts lists are composed of functional groups in ascending numerical sequence, with the parts in each group listed in figure and item number sequence. Bulk materials are listed in NSN sequence.

*b. Section III. Special Tools List.* A list of special tools, TMDE, and support equipment authorized for the performance of maintenance.

*c. Section IV. National Stock Number (NSN) and Part Number Index.* A list, in ascending numerical sequence of the National item Identification Number (NIIN), of all National stock numbers appearing in the listings, followed by a list, in alphanumeric sequence, of all part numbers appearing in the listings. National stock numbers and part numbers are cross-referenced to each illustration figure and item number appearance.

##### B-3. Explanation of Columns

The following provides an explanation of columns found in the tabular listings:

*a. Illustration.* This column 18 divided as follows:

(1) Figure number. Indicates the figure number of the illustration in which the item is shown.

(2) Item number. The number used to identify each item called out in the illustration.

*b. Source, Maintenance, and Recoverability Codes (SMR).*

(1) *Source code.* Source codes are assigned to support items to indicate the manner of acquiring

support items for maintenance, repair, or overhaul of end items. Source codes are entered in the first and second positions of the Uniform SMR Code format as follows:

Code	Definition
PA.....	Item procured and stocked for anticipated or known usage.
PB.....	Item procured and stocked for insurance purposes because essentiality dictates that a minimum quantity be available in the supply system.
PC.....	Item procured and stocked and which otherwise would be coded PA except that it is deteriorative in nature.
PD.....	Support item, excluding support equipment, procured for initial issue or outfitting and stocked only for subsequent or additional initial issues or outfittings. Not subject to automatic replenishment.
PE.....	Support equipment procured and stocked for initial issue or outfitting to specified maintenance repair activities.
PF.....	Support equipment which will not be stocked but which will be centrally procured on demand.
PG.....	Item procured and stocked to provide for sustained support for the life of the equipment. It is applied to an item peculiar to the equipment which,

Code	Definition
	because of probable discontinuance or shutdown of production facilities, would prove uneconomical to reproduce at a later time.
KD.....	An item of a depot over-haul/repair kit and not purchased separately. Depot kit defined as a kit that provides items required at the time of overhaul or repair.
KF.....	An item of a maintenance kit and not purchased separately. Maintenance kit defined as a kit that provides an item that can be replaced at organizational or intermediate levels of maintenance.
KB.....	Item included in both a depot overhaul/repair kit and a maintenance kit.
MO.....	Item to be manufactured or fabricated at organizational level.
MF.....	Item to be manufactured or fabricated at the direct support maintenance level.
MH.....	Item to be manufactured or fabricated at the general support maintenance level.
MD.....	Item to be manufactured or fabricated at the depot maintenance level.
AO.....	Item to be assembled at organizational level.
AF.....	Item to be assembled at direct support maintenance level.

<b>Code</b>	<b>Definition</b>
<b>AH</b> .....	Item to be assembled at general support maintenance level.
<b>AD</b> .....	Item to be assembled at depot maintenance level.
<b>XA</b> .....	Item is not procured or stocked because the requirements for the Item will result in the replacement or the next higher assembly.
<b>XB</b> .....	Item is not procured or stocked. If not available through salvage, requisition.
<b>XD</b> .....	A support item that is not stocked. When required, item will be procured through normal supply channels.

**NOTE**

**Cannibalization or salvage may be used as a source of supply for any item source coded above, except those coded XA, XD, and aircraft support items as restricted by AR 700-42.**

(2) *Maintenance code.* Maintenance codes are assigned to indicate the levels of maintenance authorized to USE and REPAIR support items. The maintenance codes are entered in the third and fourth positions of the Uniform SMR Code format as follows:

(a) The maintenance code entered in the third position will indicate the lowest maintenance

level authorized to remove, replace, and use the support item. The maintenance code entered in the third position will indicate one of the following levels of maintenance:

<b>Code</b>	<b>Application/ explanation</b>
<b>C</b> .....	Crew or operator maintenance performed within organizational maintenance.
<b>O</b> .....	Support item is removed, replaced, used at the organizational level.
<b>I</b> .....	Support item is removed, replaced, used by the direct support element of integrated direct support maintenance.
<b>P</b> .....	Support item is removed, replaced, used at the direct support level.
<b>H</b> .....	Support item is removed, replaced, used at the general support level.
<b>D</b> .....	Support items that are removed, replaced used at depot, mobile depot, specialized repair activity only.

**NOTE**

**Codes "I" and "F" will be considered the same by direct support units.**

(b) The maintenance code entered in the fourth position indicates whether the item is to be

repaired and identifies the lowest maintenance level with the capability to perform complete repair (i.e., all authorized maintenance functions). This position will contain one of the following maintenance codes:

<b>Code</b>	<b>Application/ explanation</b>
<b>O</b> .....	The lowest maintenance level capable of complete repair of the support item is the organizational level.
<b>P</b> .....	The lowest maintenance level capable of complete repair of the support item is the direct support level.
<b>H</b> .....	The lowest maintenance level capable of complete repair of the support item is the general support level.
<b>D</b> .....	The lowest maintenance level capable of complete repair of the support item is the depot level, performed by depot, mobile depot, or specialized repair activity.
<b>L</b> .....	Repair restricted to designated specialized repair activity.
<b>Z</b> .....	Nonreparable. No repair is authorized.
<b>B</b> .....	No repair is authorized. The item may be reconditioned by adjusting, lubrication, etc., at the user level. No parts or special tools are procured for the maintenance of this item.

(3) *Recoverability code.* Recoverability codes are assigned to support items to indicate the disposition action on unserviceable items. The recoverability code is, entered in the fifth position of the Uniform SMR Code format as follows:

<b>Recoverability Code</b>	<b>Definition</b>
<b>Z</b> .....	Nonreparable item. When unserviceable, condemn and dispose at the level indicated in position 3.
<b>O</b> .....	Reparable item. When uneconomically repairable, condemn and dispose at organizational level.
<b>P</b> .....	Reparable Item. When uneconomically repairable, condemn and dispose at the direct support level.
<b>H</b> .....	Reparable item. When uneconomically repairable, condemn and dispose at the general support level.
<b>D</b> .....	Reparable item. When beyond lower level repair capability, return to depot. Condemnation and disposal not authorized below depot level.
<b>L</b> .....	Reparable item. Repair, condemnation, and disposal not authorized below depot/specialized repair activity level.
<b>A</b> .....	Item requires special handling or condemnation procedures because of specific reasons (i.e., precious metal content, high dollar value, critical material, or hazardous material). Refer to appropriate manuals/directives for specific instructions.

c. *National Stock Number (NSN)*. Indicates the National stock number assigned to the item and will be used for requisitioning purposes.

d. *Part Number*. Indicates the primary number used by the manufacturer (individual, company, firm, corporation, or Government activity), which controls the design and characteristics of the item by means of its engineering drawings, specifications, standards, and inspection requirements, to identify an item or range of items.

#### NOTE

**When a stock numbered item is requisitioned, the repair received may have a different part number than the part being replaced.**

e. *Federal Supply Code for Manufacturer (FSCM)*. The FSCM is a five-digit numeric code listed in SB 708-42 which is used to identify the manufacturer, distributor, or Government agency, etc.

f. *Description*. Indicates the Federal item name and, if required, a minimum description to identify the item. Items that are included in kits and sets are listed below the name of the kit or set with the quantity of each item in the kit or set indicated in the quantity incorporated in unit column. When the part to be used differs between serial numbers of the same model, the effective serial numbers are shown as the last line of the description. In the special tools list, the initial basis of issue (BOI) appears as the last line in the entry for each special tool TMDE, and support equipment. When the

density of the equipments supported exceeds density spread indicated in the basis of Issue, the total authorization is increased accordingly.

g. *Unit of Measure (U/M)*. Indicates the standard or the basic quantity of the listed item as used in performing the actual maintenance function. This measure is expressed by a two-character alphabetical abbreviation (e.g., ea, in., pr, etc.). When the unit of measure differs from the unit of issue, the lowest unit of issue that will satisfy the required units of measure will be requisitioned.

h. *Quantity Incorporated in Unit*. Indicates the quantity of the item used in the breakout shown on the illustration figure, which is prepared for a functional group, subfunctional group, or an assembly. A "V" appearing in this column in lieu of a quantity indicates that no specific quantity is applicable (e.g., shims, spacers, etc.).

#### B-4. Special Information

a. Detailed manufacturing instructions for items source coded to be manufactured or fabricated are found in chapters 2 and 3. Bulk materials required to manufacture items are listed in the Bulk Material Group in section II of this appendix.

b. Detailed assembly instructions for Items source coded to be assembled are found in chapters 2 and 3.

c. Repair parts kits and gasket sets appear as the last entries in the repair parts listing for the figure in which its parts are listed as repair parts.

d. Action change codes indicated in the left-hand margin of the listing page denote the following:

- N**..... Indicates an added item
- C**..... Indicates a change in data
- R**..... Indicates a change in NSN only

e. Usable on codes are shown in the description column. Uncoded items are applicable to all models. Identification of the usable on codes used in this publication are:

Code	Used on
612 .....	Pistol, cal .45 automatic: M1911A1, w shoulder holster, w/e
163 .....	Pistol, cal .45 automatic: M1911A1 w holster, w/e

### B-5. How to Locate Repair Parts

**a. When National Stock Number or Part Number is Unknown:**

(1) *First.* Using the table of contents determine the functional group within which the repair part belongs. This is necessary since illustrations are prepared for functional groups and listings are divided into the same groups.

(2) *Second.* Find the illustration covering the functional group to which the repair part belongs.

(3) *Third.* Identify the repair part on the illustration and note the illustration figure and item number of the repair part.

(4) *Fourth.* Using the repair parts listing, find the figure and item number noted on the illustration.

**b. When National Stock Number or Part Number is Known:**

(1) *First.* Using the Index of National stock numbers and part numbers, find the pertinent National stock number or part number. This index is in ascending NIIN (the last nine figures of the NSN) sequence followed by a list of part numbers in ascending alphanumeric sequence, cross-referenced to the illustration figure number and item number.

(2) *Second.* After finding the figure and item number, locate the figure and item number in the repair parts list.

### B-6. Abbreviations

Abbreviation	Explanation
assy.....	assembly
cal .....	caliber
ed-pltd.....	cadmium plated
cham.....	chamfered
dia .....	diameter
fl-ck-hd.....	flat countersunk, head
h .....	height
lg .....	long/length
LH .....	left-hand
LOA.....	length overall
max .....	maximum
oa.....	overall
phos-ctd.....	phosphate coated
RH.....	right-hand
tk .....	stock
st/S.....	steel
thk.....	thick

## SECTION II. REPAIR PARTS LIST

(1) ILLUSTRATION		(2)	(3)	(4)	(5)	(6)	(7)	(8)
(a) FIG NO.	(b) ITEM NO.	SMR CODE	FEDERAL STOCK NUMBER	PART NUMBER	FSCM	DESCRIPTION  USABLE ON CODE	U/M	QTY INC IN UNIT
N	8-1	NA		7269655	19204	GROUP 00 REPAIR PARTS FOR: PISTOL, CAL. 45, AUTOMATIC, MAJOR GROUPS AND ASSEMBLIES  PISTOL, CALIBER .45 AUTOMATIC  GROUP 01 PISTOL, CAL. .45 AUTOMATIC, MAJOR GROUPS AND ASSEMBLIES	EA	1
N	B-1	1 PACZZ	1005-00-550-8694	5508694	19204	MAGAZINE, CARTRIDGE	EA	3
N	B-1	2 PAPZZ	1005-00-600-8597	6008595	19204	STOP, SLIDE	EA	1

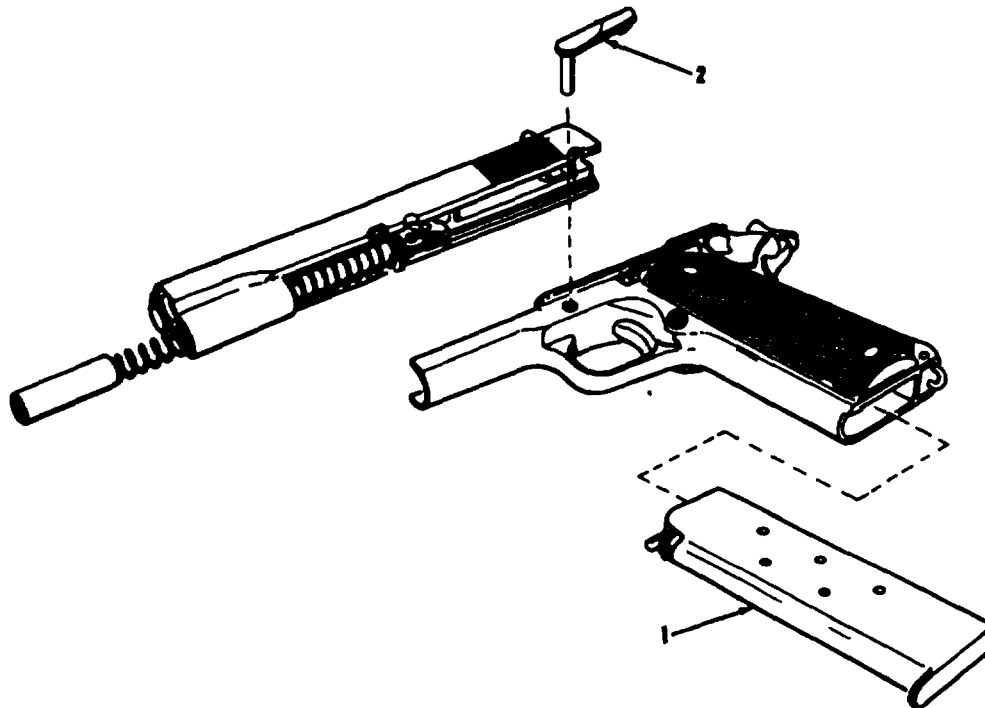

WE 17399

Figure B-1. Major groups and assemblies-partially exploded view.